

ATHLON
RIDICULOUSLY GOOD OPTICS

CRONUS ATS PRO CLIP-ON

35CL-400 | 35CL-640



QUICK START GUIDE

athlonoptics.com

- CONTENTS -

EN	CRONUS ATS PRO Clip-on Quickstart Guide	1-25
DE	Wärmebild-Zielfernrohre der CRONUS ATS PRO Clip-on-Serie Schnellstartanleitung	25-52
FR	Lunettes thermiques série CRONUS ATS PRO Clip-on Guide de démarrage rapide	53-80
IT	Ottici termici serie CRONUS ATS PRO Clip-on Guida Rapida.....	81-108
ES	Visores térmicos de la serie CRONUS ATS PRO Clip-on Guía de inicio rápido	109-136
PL	Celowniki termowizyjne serii CRONUS ATS PRO Clip-on Skrócona instrukcja obsługi.....	137-165

- IMPORTANT -

Welcome to the Athlon family and thank you for your purchase. Please read this guide before use and keep it for future reference.

This is a general guide for Cronus ATS PRO family of thermal Clip-Ons, which means that the specific model you receive may differ from the picture in this guide.

- FCC WARNING -

This equipment may generate or use radio frequency energy. Changes or modifications to this equipment may cause harmful interference unless the modifications are expressly approved in the instruction manual. The user could lose the authority to operate this equipment if an unauthorized change or modification is made.

This unit complies with part 15 of the FCC Rules. Operation is subject to the following two conditions: (1) This unit may not cause harmful interference, and (2) this unit must accept any interference received, including interference that may cause undesired operation.

The unit has been evaluated to meet general RF exposure requirement. The unit can be used in portable exposure condition without restriction.

NOTE: This equipment has been tested and found to comply with the limits for a Class B digital unit, pursuant to part 15 of the FCC Rules. These limits are designed to provide reasonable protection against harmful interference in a residential installation. This equipment generates, uses and can radiate radio frequency energy and, if not installed and used in accordance with the instructions, may cause harmful interference to radio communications. However, there is no guarantee that interference will not occur in a particular installation. If this equipment does cause harmful interference to radio or television reception, which can be determined by turning the equipment off and on, the user is

encouraged to try to correct the interference by one or more of the following measures:

- Reorient or relocate the receiving antenna.
- Increase the separation between the equipment and receiver.
- Connect the equipment into an outlet on a circuit different from that to which the receiver is connected.
- Consult the dealer or an experienced radio/TV technician for help.
- The rating information is located at the bottom of the unit

- PRECAUTIONS -



DANGER

- 1) Please charge the battery with the battery charger provided. Be sure to place the battery (+/-) in the right position. Improper battery charging will cause heating, damage and even physical injury.
- 2) Do not try to open or disassemble the battery at any time.



WARNING

- 1) This unit contains advanced electronics. To prolong the life of this unit, avoid any undue physical damage or violent actions;
- 2) Do not use or store the equipment in an environment that exceeds the allowable operating or storage temperature;
- 3) Do not directly aim the equipment at high-intensity thermal radiation sources, such as the sun, lasers, spot welding machines, etc.;
- 4) Avoid allowing debris to enter any ports in this optic.
- 5) Do not knock, throw or vibrate instruments and accessories to avoid damage;
- 6) Any modification, alterations or attempts to disassemble this unit will void the user's warranty. All repairs must be made through Athlon Optics.
- 7) Avoid contaminating this unit with oils or solvents.

- 8) Please observe the following measures when wiping this unit:
- Non-optical surface: Use clean and soft cloth to wipe the non-optical surface of the thermal unit;
 - Optical surface: When using the thermal unit, avoid contaminating the optical lens surfaces of this unit. Avoid touching the objective lens with your hands. Oils and solvents, can degrade the lens coatings. When the surface of the optical lens is polluted, use special lens paper to wipe it carefully;
- 9) Do not place the battery in a high temperature or near a high-temperature object;
- 10) Do not short circuit the positive and negative poles of the battery;
- 11) Do not expose the battery to moisture or water;
- 12) Only use the original chargers and adapters provided with this unit.

- PRODUCT INTRODUCTION -

Athlon Optics thermal Clip-on can be mounted through included QD mount in front of a LVPO optical sight or clipped on the objective side of a traditional hunting scope through an optional adapter.

- STORAGE AND TRANSPORTATION -

The following is the correct storage and transportation of the product. To prevent damage to yourself or the unit, please read the manual carefully before using it.

STORAGE:

1. The unit and accessories including batteries shall be stored in a well-ventilated, clean, condensate-free and corrosive gas-free room with temperature of $-22^{\circ}\text{F} \sim 140^{\circ}\text{F}$ ($-30^{\circ}\text{C} \sim 60^{\circ}\text{C}$) and relative humidity not exceeding 95%.
2. To prevent battery damage, the unit and batteries should be charged every 3 months.

TRANSPORT:

During transport, it shall be protected against rain, water flooding, without severe vibration and impact.

- LIST OF PARTS -

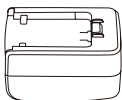

5V2A adapter
x1

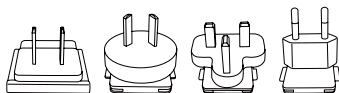

Adapter plug:
EU x1, UK x1, US x1, AU x1



Battery
x 2

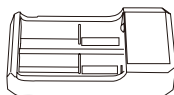

Battery charging stand
x 1

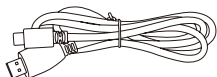

USB-C Cable
x 1



Quick Start Guide
x 1



Warranty card
x 1

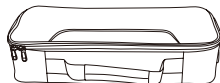

Carrying Case
x 1

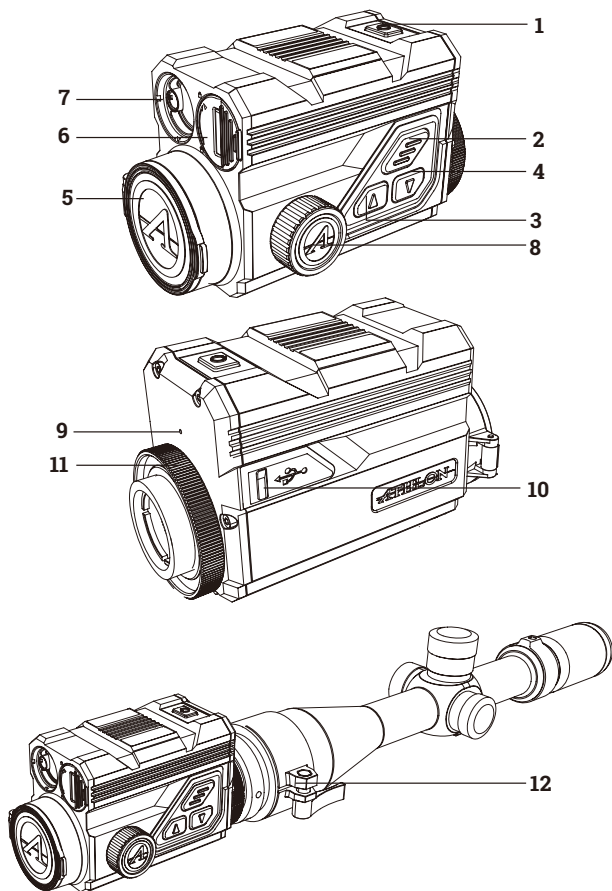

No.	Description	Function
1	Power Switch	Short press: shutter compensation/ wake-up/exit menu Long press: power on/off
2	MENU	Short press: activate the shortcut menu/confirm to save the settings Long press: activate the main menu/ exit the current menu without saving
3	UP	Short press: photo/changing menu option Long press: video recording/changing menu option
4	DOWN	Short press: activate ranging/single ranging Long press: activate ranging mode selection menu
5	Lens Cap	Lens protection
6	Battery Compartment	Battery Chamber
7	Laser Rangefinder	Built-in laser rangefinder
8	Focusing Knob	Rotate the knob to focus
9	MIC	Sound recording port
10	Type-C Port	Connection with PC and external screen via type-C cable
11	Locking Ring	Locking scope adapter to the unit
12	Adapter Ring	Connection with the unit and the riflescope (optional)

BATTERY INSTALLATION

- Lift the battery compartment lever up and twist to open the battery cover;

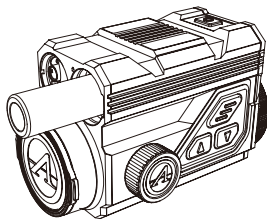

- Insert 2 batteries with the "+" facing inward, and "-" facing outward;
- Close the battery compartment cover;

DATA TRANSMISSION

- Turn on the unit;
- Connect the unit to the PC via USB-Type C cable;
- Access the data stored in the unit from the PC;

MOBILE APP CONNECTION

- Turn on the unit;
- Turn on the WiFi in the unit;
- Search the unit's WiFi name with the mobile phone and connect to the WiFi;
- Open the Athlon Thermal APP on the mobile phone to change settings, live view, and access video and image stored in the unit.

-BUTTON DESCRIPTION-

1. POWER BUTTON

POWER ON:

Long press and hold the power button until the startup picture appears in the eyepiece.

▲ NOTE: If the battery is completely discharged, the unit can be turned on with external battery pack using the included USB-C cable and port.

POWER OFF:

- a. **Manual power-off:** long press and hold the power button, the power-off progress bar will be displayed, and the power-off is completed after the progress bar is finished.
- b. **Automatic power-off:** In the set automatic power-off time (15/30/60 minutes), without any button operation, the unit will power down.

DISPLAY OFF:

Press and hold the power button, the progress bar of power-off will be displayed. Before the progress bar is finished, release the power-off button to cancel the power off process to activate the display off mode.

DISPLAY ON•

In the display off mode, press any button to wake the screen.

COMPENSATION•

When it is turned on and the menu is not activated, short-press the power on/off button to refresh the thermal sensor. Two Compensation modes, manual and automatic, can be set through the Main Menu.

2. MENU BUTTON

When the menu is not activated, short press to activate the shortcut menu. Long press to activate the main menu.

When the menu is activated, short press to enter the next level and confirm the current selection.

Long press to return to the upper level menu and exit the menu without saving the current settings.

3. UP BUTTON

TAKE PHOTOS•

When it is turned on and the menu is not activated, short-press the Up button to take a photo.

VIDEO RECORDING•

When it is turned on and the menu is not activated, long press the Up button to start recording, and then long press and hold the Up button again to stop recording. During the video recording, short-press the Up button to snap pictures.

CHANGING MENU OPTION•

When it is turned on and the menu is activated, short press to change the menu options.

4. DOWN BUTTON**SINGLE RANGING MODE•**

When it is turned on and the menu is not activated, short-press the Down button to activate laser ranging and perform single ranging. Long press the Down button to activate the ranging mode selection menu.

CHANGING MENU OPTION•

When it is turned on and the menu is activated, short press to change the menu options.

- FUNCTION DESCRIPTION -

1. SHORTCUT MENU

- **Color Palettes:** Can be set in white hot/black hot/adjustable red hot/iron red/blue hot/green hot/sepia.
- **Screen BRI:** Screen brightness can be adjusted a total of 1-10 levels.
- **WiFi:** WiFi can be used to transmit real-time video to the mobile phone after the mobile phone is connected to your unit, and the unit can be operated through the Athlon Thermal APP to access the photos/videos of the unit; photos/videos can be played, shared, deleted, etc.
 - ▲ **NOTE: Search and download Athlon Thermal APP in the mobile phone APP store, open the APP, find the WiFi name 'Cronus ATS PRO XX-XXX' in the settings of mobile phone WiFi, and enter the password '12345678', to start remote operation after successful connection.**
- **Hot Track:** a white cross cursor is displayed when it is turned on to trace the highest temperature point in the full image.
- **Eco Mode:** After being turned on, the unit will switch to power-saving mode, under which OLED brightness will be fixed to 20% and cannot be adjusted, and WIFI will not be turned on. If the current WIFI is already on,

WIFI will be turned off, and the shooting record function cannot be turned on. If you are currently in shooting recording mode, the prompt is turned off.

- **Zero Calibration:** Zeroing distance can be adjusted and stored at distance of 50, 100, 200, 300, 500 in yard or meter. The shortcut menu offers quick access to switch among the preset zero distances of a profile from the main menu.

▲ NOTE: Only select the distances that have been zeroed, and do not select the distance still set at default factory X/Y value (0,0).

2. MAIN MENU

LASER RANGING

- **Ranging Mode:** Single ranging/continuous ranging can be selected.
- **Continuous Ranging Time:** 5/10/20 seconds can be selected.
- **Ranging Cursor Color:** Can be selected in orange/white/blue/green.
- **Ballistic Calculator:** Can be turned on and off. Ballistic profiles must be created and uploaded to the unit through the Athlon Ballistics APP first. Under both single and continuous ranging mode, the ballistic holdover data MOA or MIL will be displayed on the screen.

- **Angular Measurement:** MOA and MIL can be selected.

IMAGE QUALITY ADJUSTMENT

- **Scene Mode:** Three scene modes, natural/enhanced/highlight, can be set.
- **Brightness:** Adjustable for 1-10 levels.
 - ▲ **NOTE: The adjusted brightness value will be saved in the current scene mode.**
- **Contrast:** Adjustable for 1-10 levels.
 - ▲ **NOTE: The adjusted contrast value will be saved in the current scene mode.**
- **Image Enhancement:** Turn on to enhance the image quality.
- **Compensation Mode:** Two optional compensation methods: automatic compensation and manual compensation. Short press the power button to perform the manual compensation when unit is powered on.

MENU & ZEROING SETTING

- **Menu Scaling:** To scale the menu size at 1X/3X/6X. 1X is the largest option.
- **Menu Position:** Short/long press the Up/Down button to change the position of the menu on the screen.
- **Profile Configuration:** 5 groups of zeroing profiles, from A-E can be saved. The zeroing distance, cartridge, and rifle information are saved for each profile.
- **Zeroing Settings:** Set zeroing distance at 50, 100, 200, 300, 500 yard or meter for each profile. Follow one shot zeroing process.

- ONE SHOT ZERO CALIBRATION -

Select a distance from 50/100/200/300/500 yards or meters to start one shot zero calibration. After zero is set, use the shortcut menu to switch among the preset zero distances under each profile.

Aim the center of the riflescope reticle at the center of the target, and hold the rifle as stable as possible and fire a bullet. Press the Menu button to turn on the freeze option in the pop-up window showing "X" and "Y" while making sure the center of the riflescope reticle is still pointing at the center of target.

Use the Up or Down button to navigate and adjust the value of “X” (move left and right) or “Y” (move up and down) to move the actual point of impact until it overlaps with the center of the riflescope reticle. Use the Up or Down button to select the “Confirm” option in the Pop up window, and short press the Menu button to confirm it.

The vertical zero offset value can only be set through Athlon Ballistic APP.

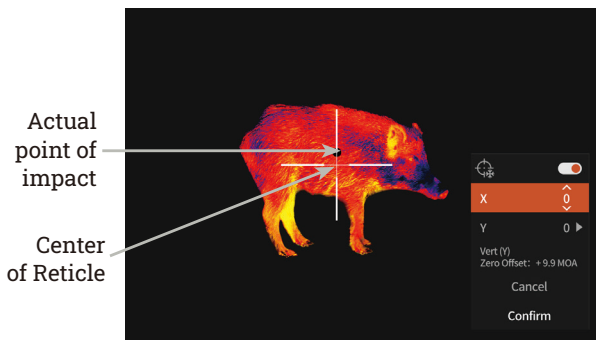

RECORD SETTINGS

- **Audio Input:** When the microphone is turned on, you can record audio while recording video, so that the sound is integrated into the video files.
- **Auto-Shot Record:** When this function is turned on, it will automatically record a video and 5 images when the user shoots (video: 3 seconds before shooting ~ 7 seconds after shooting). If a shot is made within the 7 seconds, the unit will continue recording for 30 minutes.
- **Auto-Shot Sensitivity:** Shooting trigger sensitivity, divided into 1-5 settings; the 5th setting is the most sensitive setting.
- **Manual record clip duration:** 15/60 second clip duration can be selected to automatically end video recording within the time selected.
- **On Screen Display:** If OSD is turned on, all elements on the screen will be embedded in the images and video files. If OSD is turned off, no elements on the screen will be embedded in the images and video files, but all elements will still be displayed on the real-time screen.
- **Watermark Settings:** If watermark is enabled, the time and date will be displayed on the bottom right corner of the screen and be embedded in the photos and videos.
- **Time:** Set the time on the device, and the results will be synchronized to the watermarked display.

- **Date:** Set date on the device, and the results will be synchronized to the watermarked display.

POWER SETTING

- **Sleep Mode:** The Auto Sleep time can be set to 5/10/15 minutes. If there is no operation within the set time, the unit will enter sleep mode.
- **Auto Power-off:** The automatic Power-off time can be set to 15/30/60 minutes. If there is no operation within the set time, the power-off will be activated, and the unit will be powered off.
- **Timed menu off:** the menu can be turned off automatically within 10/20/60 seconds.

LOCAL SETTINGS

- **Language Setting:** Available in English/French/German/Italian/Spanish.
- **Unit Measurement:** yard or meter.
- **Time Formats:** Selectable between 12H/24H.
- **Date Formats:** Optional from MM-DD-YYYY/YYYY-MM-DD/DD-MM-YYYY.

- **Time Setup:** Enter the Time Setup, press the Menu button to move among different options, and press the Up or Down button to enter the next level adjustment, and then press the Menu button to move between the specific time values.
- **Black Screen Indication:** Black screen indication icon can be turned on and off.
- **Bluetooth:** Used to connect to a Bluetooth remote control, thereby controlling the unit through remote control.
- **Memory Capacity:** free memory capacity/total capacity.
- **Memory Formatting:** Select Memory Formatting. Select "Confirm" to confirm formatting, and select "Cancel" to cancel the operation
- **Restore default:** You can choose to restore the factory settings. Select "Confirm" to restore all parameters to factory settings; Select "Cancel" to cancel the operation.
- **About:** Check the current unit in the APP version number and MAC address.

- FIRMWARE UPDATE -

To get the latest version of firmware for improved performance and better image quality, please use either of the following methods to complete the update:

UPDATE VIA APP

- 1) Power on the thermal unit and turn on the units WiFi through the main menu.
- 2) Connect mobile phone with the WiFi of the thermal unit.
- 3) Open the Athlon Thermal mobile APP and click the "About Device" link.
- 4) Make sure the mobile device has cellular data connection and then tap the "Check for updates" button.
- 5) If there is an update available, it will appear on the screen. Tap the "Download" button and wait for 100% completion.
- 6) After the download is completed, tap the "Update" button to start the transferring process.
- 7) Once the firmware transferring is completed, the APP will show "Transfer completed!" on the top of the screen.

The screen of the thermal unit will show the options "Delete" "Cancel" and "Update." Use the Up or Down button to select the "Update" and press the M button to confirm.

Once the progress bar shows 100% completion, power off and on the thermal unit to begin enjoying the new firmware.

UPDATE VIA COMPUTER

1) Download the firmware package to your computer.

- To download the firmware package, visit the following URL:
<https://athlonoptics.com/thermal-firmware-update/>

▲ NOTE: if you accidentally download the update package twice, please use the file named ota-asic.img not ota-asic(1).img. The exact file name must be used.

2) Turn on thermal unit to "Com Mode."

- To enter "Com Mode," long press the power button and Menu button at the same time when the unit powers on, then release the power button while continuing to press the Menu button.
- "Com Mode" icon should appear at lower left corner.

3) Connect the thermal unit to your computer.

- Use type C cable to connect the thermal unit to your computer.

4) Copy the downloaded firmware package to your computer.

- On your computer, copy the downloaded firmware package (ota-asic.img) to the root directory of the Thermal USB drive.

- Turn off the thermal unit, then turn it back on. The firmware will update automatically.

5) Check if firmware updated successfully.

- Long press the Menu button to activate the Menu.
- Use the Up or Down button to navigate and short press the Menu button to select the Local Settings. Go to the About screen and confirm the ASIC number matches the number listed with the update package. If it matches, then the firmware has updated successfully.

- TROUBLESHOOTING -

1. UNIT FAILS TO START.

Solution: Replace the battery or connect the adapter for charging.

2. THE UNIT CANNOT TAKE PHOTOS/RECORD.

Solution: the internal storage space of the unit may be full, check the internal memory capacity.

3. THE UNIT DISPLAY TIME DOES NOT MATCH THE ACTUAL TIME DISPLAY.

Solution: Reset the time and date of the unit in the menu.

4. SCREEN GOES OUT DURING USE.

Solution: Short-press any button to wake up the unit from sleep mode and activate the screen.

5. THE UNIT IS UNRESPONSIVE TO ANY NORMAL INPUT

Solution: Long press the Menu button and the Power button simultaneously for 15 seconds to have a hard Power-off and then power it on normally.

- DETAILED OPERATION -

To view a detailed instruction manual, please visit the product page on our website

www.AthlonOptics.com

**SHARP, TIGHT
AND PRICED
JUST RIGHT!**

Toll free: 1-855-913-5678

contact@athlonoptics.com

**10817 RENNER BLVD,
LENEXA, KS 66219**

athlonoptics.com